

BD - 05T Series - Micro Diaphragm Pump

Model:BD-05TVB-S.1

| Performance Data | |
|---------------------------|-----------------------|
| Model | BD-05TVB-S.1 |
| Voltage range | 12/24V |
| Maximum flow | 5.5L/min |
| Maximum negative pressure | -70KPa |
| Max positive pressure | 1~1.5Bar |
| Motor Data | |
| Motor type | DC brushless motor |
| Max power | 4W |
| Waterproof lever | IP20 |
| Physical Properties | |
| Storage temperature | -40℃~60℃ |
| Operating environment | -20℃~50℃ |
| Medium temperature | -10℃~45℃ |
| Material | |
| Head of pump | PPS |
| Diaphragm | EPDM(Customized FKM) |
| Valve | EPDM(Customized FKM) |
| Pump body | Nylon |
| Dimension | 60.4*32*55mm |
| Weight | 148g |



Features

Optimized pump body to ensure small volume, provide large flow and maintain relatively low power consumption.

The gas flow is stable and the motor runs in a wide range.

- High performance
- Dc brushless motor lifetime 8000hours
- Imported ball bearing material design
- Professional seal design ensures low leakage rate
- Pollution-free sample gas
- High quality imported EPDM and FKM rubber materials, withstand a variety of gas corrosion

Drawing(mm)

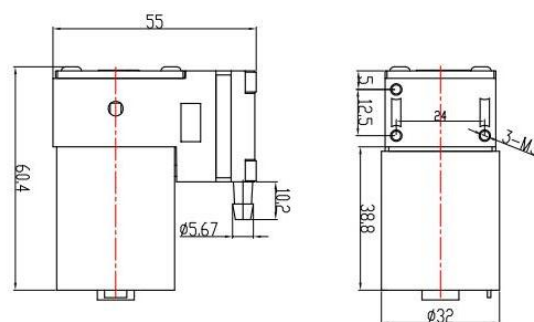

Curve

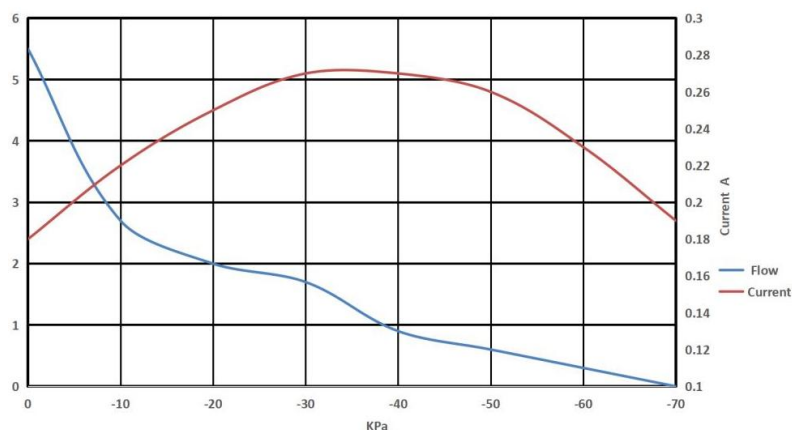

Wiring instructions

- **Red wire:** Power positive
- **Black wire:** Negative power supply
- **Blue wire:** PWM (connected to positive full speed)
Speed Control Negative Duty Cycle Range 4%-100%
The recommended output PWM frequency is 20K.
- **Yellow wire:** FG, 5V pulse signal, 3Pulse/Cycle
0-5V TTL Pulse